



IS | ES | RC | RC F | LS | LC | UX | RX | GX

LEXUS TECHNOLOGY QUICK GUIDE

LEXUS TECHNOLOGY QUICK GUIDE

Obey traffic regulations and maintain awareness of the road and traffic conditions at all times.

 BLUETOOTH® PHONE	Connects your mobile device to your Lexus	2
 LEXUS SAFETY SYSTEM+	Advanced safety features	3
 LEXUS ENFORM	Registration procedure	4
 SAFETY CONNECT*	Emergency services at the press of a button	5
 SERVICE CONNECT*	Vehicle health report, maintenance notifications, vehicle alert notifications and more	6
 LEXUS NAVIGATION SYSTEM*	Easily get the best route to an address or point of interest with the built-in navigation system	7
 REMOTE*	Remotely start the engine, lock/unlock doors, find vehicle's last parked location and more	8
 APPLE CARPLAY®	Enables your vehicle's multimedia system to display and act as a controller for your iPhone	12
 ANDROID AUTO™	Seamlessly casts your device's interface onto the vehicle's multimedia display	14
 AMAZON ALEXA	Access Alexa services & skills on the road	16
 VOICE COMMAND	Controls various features like phone, audio and climate control	17
 WI-FI*	Allows the connection of up to 5 devices to the internet at the speed of 4G LTE	20
 REMOTE TOUCH SETTING	Adjust feedback force of the remote	21
 TECHNOLOGY SUPPORT	Resources available to assist you	23

* Trial subscription included. View www.lexus.com/enform for full details.



Compatible Bluetooth®-equipped phones can be connected to the vehicle, enabling hands-free operation. Please refer to the cellular phone manufacturer's user guide for pairing procedures, or go to www.LexusDrivers.com for more phone information.

To Pair a Compatible Bluetooth®¹ Phone



1. Press the “MENU” switch on the Remote Touch and select:
“Setup”
“Bluetooth”
“Add New Device”
Select your smart phone.



2. If needed, enter the passcode displayed on the screen into the phone. Some phones may require approval of additional phone prompts to allow available Bluetooth® functions to operate. Refer to the mobile phone user's manual for mobile phone operation.



3. If “Connected” is displayed, registration is complete.

TIPS

- To adjust volume the other party hears during a call, click Full Screen View icon*  and select “Transmit Volume” on screen. Follow the prompts.
- To adjust volume you hear during call, use the steering wheel switch or the “PWR-VOL” knob.
- For more information, see the Phone section of the Navigation System Owner's Manual or the cellular phone manufacturer's user guide.

* If equipped



Lexus Safety System+^A is designed to help protect drivers, passengers, people in other vehicles on the road and pedestrians from harm. This system is composed of advanced active safety packages anchored by automated pre-collision warning^B and braking, addressing three of the most common accident types: frontal collisions, unintended lane departures and nighttime accidents.

Find Quick Guides and more information at: <https://LexusDrivers.com/LSS>

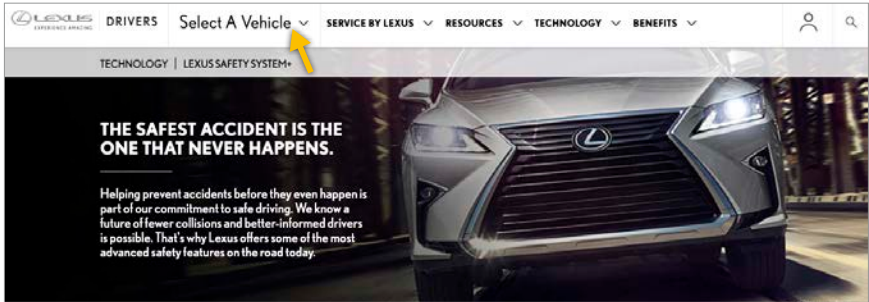

STEP 1. Go to Select a Vehicle
Select vehicle model and year.

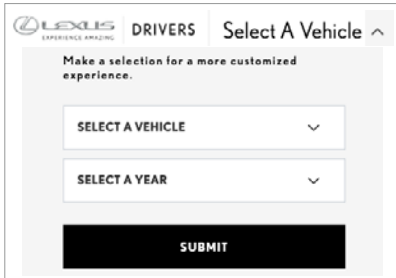

STEP 2. Find Quick Guide
Scroll down and click on Quick Guide.*



Lexus Safety System+ is comprised of four systems (with some variations shown here):

1. Pre-Collision System with Pedestrian Detection^E | Left Turn Intersection Support^{**}
2. Lane Departure Alert^C
3. Intelligent High Beams^D
4. Dynamic Radar Cruise Control^F

Lexus Safety System+ 2.0 and 2.5 include two additional features:

5. Road Sign Assist^{G†}
6. Lane Tracing Assist^{H†}

Lexus Safety System+ A is also available on Lexus LS vehicles. Information can be found at <https://LexusDrivers.com/LSS> after selecting vehicle model and year.

*If a Quick Guide is not available, use the vehicle's Owner's Manual.

**Available only on 2021 Lexus IS vehicles.

† If equipped

Registration¹

Dealer-Assisted Lexus Enform Registration

Contact your dealership Lexus Technology Specialist for assistance in registering for Lexus Enform products.

Customer Self-Registration for Lexus Enform Products

STEP 1. Download the “Lexus” app from the App Store or Google Play Store.

STEP 2. Login using your Lexus Drivers account, or create a new account and verify your email address.

STEP 3. Add your vehicle by entering or scanning the VIN*.

STEP 4. View and enable your connected services trials.

STEP 5. View your dashboard; scroll up and down to see additional information cards.



Lexus
Android



Lexus iOS

* The VIN can be found on vehicle registration and insurance documents or inside the driver's door.



Whether you're involved in an accident, your vehicle is stolen, or the unexpected occurs, assistance can be sent directly to your vehicle's GPS location.

STOLEN VEHICLE LOCATION



Once a police report is filed, the Safety Connect Response Center can work with police to help track and recover your stolen vehicle using Safety Connect's embedded cellular and GPS technology. This may help to recover your vehicle more quickly, minimizing the amount of damage incurred. The Stolen Vehicle Location system works across the continental U.S. A valid Lexus Enform Safety Connect subscription is required after trial expiration.

ROADSIDE ASSISTANCE



With the added benefit of GPS technology, Lexus Roadside Assistance makes standard roadside service even more convenient than other services on the market. Whether your vehicle has run out of gas, has a flat tire, needs to be towed or requires a jump-start, assistance can be sent to your vehicle's location—all at the press of the Emergency Assistance button (SOS). A valid Lexus Enform Safety Connect subscription is required after trial expiration.

EMERGENCY ASSISTANCE BUTTON (SOS)



Whether it's a health emergency, a traffic accident or some other urgent situation where help is required, a single press of the Emergency Assistance Button (SOS) can connect you to a 24-hour Safety Connect response center agent. Using your vehicle's GPS technology, the agent can send emergency services to your vehicle's location while offering to stay on the line with you until help arrives. A valid Lexus Enform Safety Connect subscription is required after trial expiration.

AUTOMATIC COLLISION NOTIFICATION



In the event that your vehicle's airbags deploy or you're involved in a severe rear-end collision, you'll be automatically connected to a Lexus Safety Connect response center agent. After attempting to speak to the occupants, the agent will notify local emergency services of the situation and direct them to your vehicle's location. A valid Lexus Enform Safety Connect subscription is required after trial expiration.



Keeping up with your vehicle's health has never been easier. Get updates on everything from fuel level and mileage to maintenance alerts and more via email or the mobile app. You will receive an e-mail once Service Connect has been successfully activated.



VEHICLE HEALTH REPORT

Your vehicle health report provides important information including fuel level, vehicle mileage, smart key battery status, engine oil quantity, recent changes to Lexus Personalized Settings, and more. You can view the reports on your desktop, tablet, or phone by visiting LexusDrivers.com or using the Lexus mobile app. For the ultimate in service convenience, you can choose to have a dealer automatically call you to help schedule a service or check the status of your vehicle.

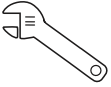

VEHICLE & MAINTENANCE ALERTS

The best care is preventive. Available Lexus Enform Service Connect provides vehicle alerts and maintenance alerts to both you and your dealer. Should you opt-in to this convenient service, your dealer can contact you directly to help keep your vehicle running at its best.



LEXUS NAVIGATION SYSTEM*



DESTINATION ASSIST^{1, 2, 6}



Destination Assist gives you 24-hour access to a live response center agent to help you locate a specific business, address or point of interest. If you're searching for a restaurant, the agent can help you narrow your choices by distance or type of cuisine and remotely send the destination to your vehicle's

Navigation System. A valid Lexus Enform subscription is required after trial expiration.



DYNAMIC NAVIGATION⁹

Dynamic Navigation provides guests with the most up-to-date map data, routes and POIs on their embedded system through real-time updates downloaded from the cloud. A valid Lexus Enform subscription is required after trial expiration.



DYNAMIC VOICE COMMAND

Dynamic Voice Command provides more conversational commands. Place compatible Bluetooth[®]-enabled* phone calls and operate climate, and navigation functions using simple voice commands.

* For vehicles equipped with Lexus Navigation System.

The Lexus Enform Remote lets you lock and unlock doors, start the engine, find your vehicle in a parking lot and monitor guest drivers.



ENGINE START/STOP

Remotely start your vehicle to warm or cool the interior based on the last climate-control settings. The engine or hybrid system will run for up to 10 minutes or until any door is opened, the brakes are pressed, or the engine is turned off remotely.



VEHICLE FINDER

Easily locate your vehicle on the street or in an uncovered parking lot using the Vehicle Finder map on your smartphone.



GUEST DRIVER MONITOR

Receive instant alerts if the vehicle is started or if it exceeds preset limits on speed, curfew, miles driven, engine run time, total elapsed time or distance from a set location.



DOOR LOCK/UNLOCK

Remotely lock and unlock your doors, receiving confirmation if the action was successful. When you unlock your Lexus remotely, the doors will automatically relock after 30 seconds* if no further action takes place.



VEHICLE STATUS AND ALERTS

Remotely check the status of your vehicle's doors, windows, moon roof, trunk, and hood, as well as the vehicle's current fuel level, odometer or trip mileage. The system can also notify you with customizable alerts.

NOTE: For key fob engine start/stop: Press the lock button twice and then hold it down on the third press; the vehicle will start or stop.

* Timing can be adjusted through Lexus Personalized settings. See your Lexus dealer for more information.



Lexus Enform Remote with Smartwatch Functionality

Add Lexus Enform Remote to your smartwatch.

- For Apple Watch, select “Watch App” on phone. Select “Lexus” and toggle “Show App on Watch.”
- For Android, open “Play Store” on your watch and look for the “Apps on your phone” section. Select “Lexus” and click the arrow to install.



The Lexus skill for Amazon Alexa¹¹ lets you use your active Lexus Enform Remote¹¹ service with any Alexa-enabled device, such as Amazon Echo, Echo Dot, and Echo Show.

1. GETTING STARTED

Search for “Lexus” in the Alexa app under “Skills,” then click “Enable.”

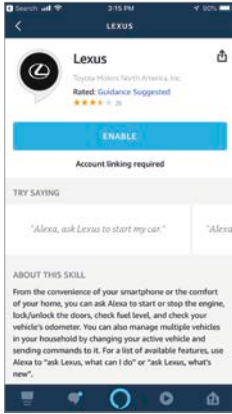

2. LOG-IN

Log in with your Lexus Drivers account.

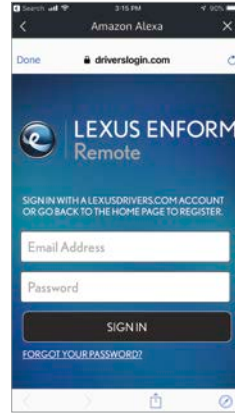

3. SET PIN

Choose your vehicle and set a 4-digit PIN.

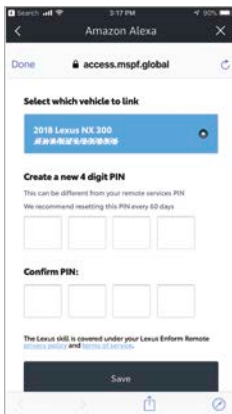

4. BEGIN USING

Lexus skill is now ready to use.



Now that you're ready to go, you can say:

- Alexa, ask Lexus to start my car.
- Alexa, ask Lexus, are my doors locked?
- Alexa, ask Lexus to lock my doors.
- Alexa, ask Lexus to check my fuel.
- Alexa, ask Lexus, is my engine running?
- Alexa, ask Lexus to fire up my ride!

The Lexus action for the Google Assistant¹² lets you use your active Lexus Enform Remote^{1,4} service with any Google Assistant-powered device, such as Google Home or Google Home Mini, or the Google Assistant app on your smartphone⁵.

1. GETTING STARTED

Search for “Lexus” in the Google Assistant app under “Explore” and click “Link.”

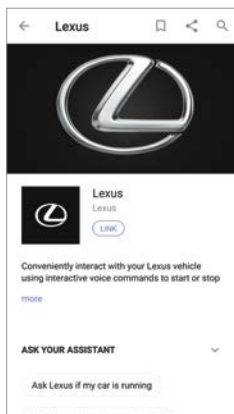

2. LOG-IN

Log in with your Lexus Drivers account.



3. SET PIN

Choose your vehicle and set a 4-digit PIN.

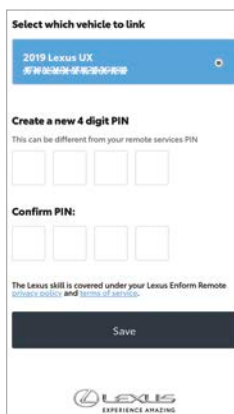

4. BEGIN USING

Lexus action is now ready to use.



Now that you're ready to go, you can say:

- Google, ask Lexus to start my car.
- Google, ask Lexus, are my doors locked?
- Google, ask Lexus to lock my doors.
- Google, ask Lexus to check my fuel.
- Google, ask Lexus, is my engine running?
- Google, ask Lexus to fire up my ride!



Works with
Apple CarPlay

The Newest iPhone Accessory: Your Lexus

With Apple CarPlay^{®13} integration, you can access the same familiar interface from your iPhone[®] through the vehicle's multimedia display.

Simply connect your iPhone to get directions, make calls, send and receive messages via Siri,^{®13} and to get access to popular apps like Spotify,[®] Audible[®] and Apple Podcasts.^{™15}



1. GETTING STARTED

Ensure Siri is enabled on your iPhone under Settings > Siri & Search.

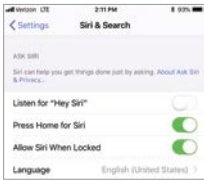

2. CONNECT

Connect your iPhone to your vehicle using a certified USB cable. You may need to unlock your iPhone, and click "Allow" to allow CarPlay while your phone is locked.



The Newest Android Accessory: Your Lexus

With Android Auto^{®14}, you can seamlessly cast your device's interface onto the vehicle's multimedia display.

Play your music via your favorite apps like Spotify[®] and Pandora[®], send messages through apps like WhatsApp[®], navigate with Google Maps[™] and verbally request information through Google Assistant¹².

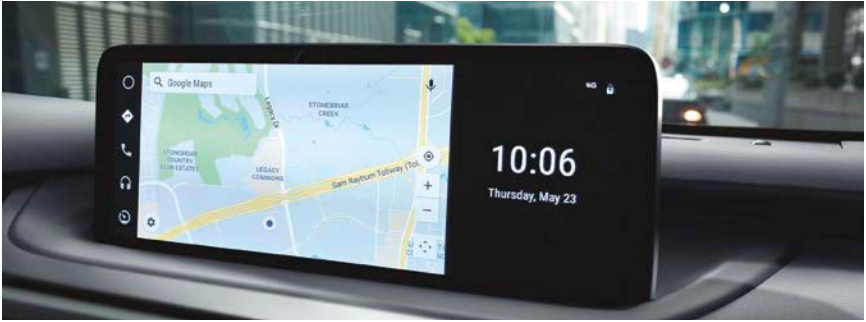

1. GETTING STARTED

Download the Android Auto app from the Google Play Store.



2. CONNECT

Connect your Android phone to your vehicle using a supported USB cable.



3. ENABLE

Press "On" to enable Android Auto when prompted on your multimedia system.

If this popup is not shown, or if you want to change the setting later, go to Menu > Setup > General > Projection Settings, and toggle Android Auto setting to ON.

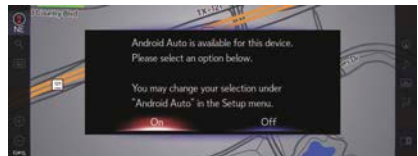

4. SET UP APP

Unlock your phone and follow prompts to set up the Android Auto app.

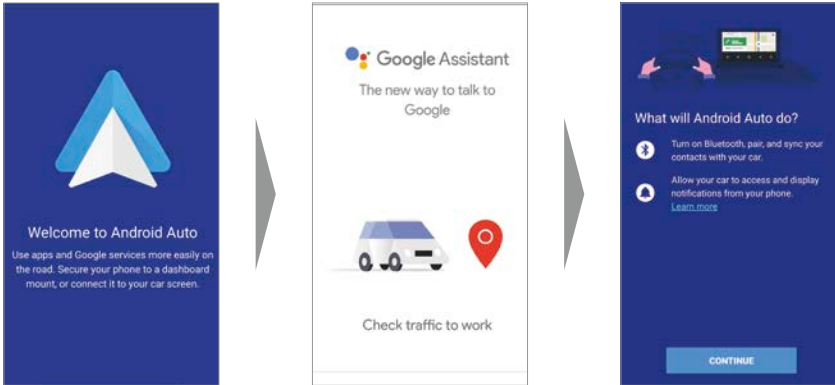

5. LAUNCH ANDROID AUTO

Launch app by pressing the Menu button on the Remote Touch interface, then select Android Auto.



If this icon says Projection, make sure your phone is connected with a compatible USB cable to your vehicle's USB media port.

6. TRY IT OUT

Once app is open, tap the icons on the left to view the home screen, get directions, make calls, or listen to music.

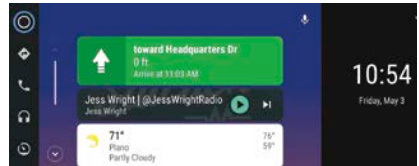

7. ACTIVATE GOOGLE ASSISTANT

To activate Google Assistant, press and hold the Voice Command button on your steering wheel.

You can also access the Lexus Voice Command system using a short tap.



Lexus+Alexa: Getting Started

Listen to audiobooks, play favorite music, check weather, get news briefings, and much more. Control compatible smart-home devices like lighting, thermostat and security systems. Alexa¹¹ even syncs to your Navigation, providing on-the-go recommendations¹⁶.

1. DOWNLOAD ENFORM APP SUITE 2.0

Download and install Enform App Suite 2.0 from the Google Play Store or the App Store. Launch Enform App Suite 2.0 and follow instructions.

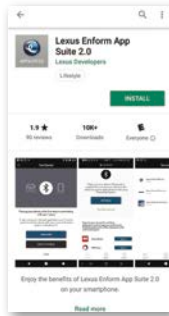

2. INSTALL LEXUS+ALEXA

Install Lexus+Alexa from the Google Play Store or the App Store.

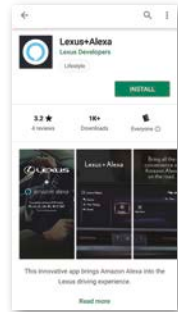

3. OPEN LEXUS+ALEXA

Open Lexus+Alexa and log in with your Amazon credentials; follow app instructions.



4. PAIR YOUR PHONE

Pair your phone to vehicle via Bluetooth¹⁷, then launch Lexus+Alexa from App Suite 2.0. For Bluetooth pairing instructions, refer to Page 1 of this guide.

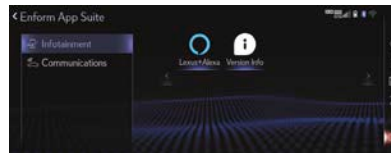

5. ASK ALEXA

You're ready to Ask Alexa!
Just say "Alexa," wait for the chime, and state your request.

- Alexa, what is the forecast?
- Alexa, play music.
- Alexa, find the nearest coffee shop.
- Alexa, turn on the front porch light.



Learn, Calibrate and Use Voice Command

LEARN AND USE SYSTEM BASICS



The built-in voice command system uses a menu-based structure.

To use the system, push the  switch on the steering wheel.

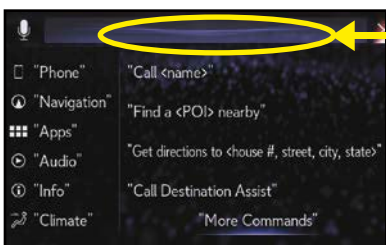

Speak normally and without pauses after the beep ends and while the wave icon on the screen is moving. This is when the system is listening.

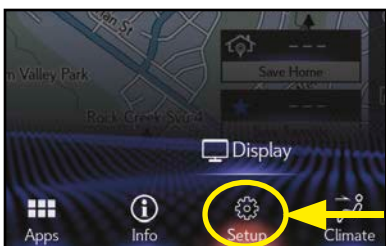

To shorten the time for the beep, turn off the voice recognition prompts:

Select "MENU," "Setup," "Voice," "Voice Recognition Prompts," set to "Off."

Say commands like the examples on pages 16 to 17.

TRAIN VOICE RECOGNITION (OPTIONAL)



The system will offer Voice Training, or you can select "MENU," "Setup," "Voice," or "Train Voice Command" to help train the voice command system to adapt to your voice. Read back ten voice recognition phrases to help tune the system to recognize your voice. After training the system, follow the example commands shown on the screen.



Frequently used commands and their related actions:

COMMON COMMAND	ACTION
Help	Displays examples of some of the available commands
Go back	Returns to the previous screen
Cancel	Cancels the voice command system
Start over	Returns to the top menu screen
Pause	Temporarily pauses a voice session until it is resumed by pressing the talk switch again
Show command examples for "menu"	Displays the command list of the selected menu
More commands	Displays the commonly used commands
Voice settings	Displays Voice Settings screen
Train my voice	Displays Train Voice Recognition screen

PHONE COMMAND	ACTION
Send <digits>	Sends DTMF tones as specified
Mute	Mutes the microphone (other party cannot hear conversation)
Unmute	Unmutes the microphone
Call <contact>	Places a call to the specified contact from your phone book
Call <contact> <phone type>	Places a call to the specified phone type of contact from your phone book
Dial <phone number>	Places a call to the specified phone number
Redial	Places a call to the phone number of the latest outgoing call
Call back	Places a call to the phone number of the latest incoming call
Show recent calls	Displays the Call History screen
Send a message to <contact>	Sends a text message to specified contact from your phone book

TEXT MESSAGE COMMAND	ACTION
Read message	Reads the incoming message over the vehicle speakers
Ignore	Ignores the incoming message notification
Reply	Initiates sending a reply to the incoming message
Call	Places a call to the phone number of the incoming message

APP COMMAND	ACTION
Launch <app>	Launches the selected app



Frequently used commands and their related actions (continued):

AUDIO COMMAND	ACTION
Play playlist <name>	Plays tracks from the selected playlist
Play artist <name>	Plays tracks from the selected artist
Play song <name>	Plays the selected track
Play album <name>	Plays tracks from the selected album
Play genre <name>	Plays tracks from the selected genre
Play composer <name>	Plays tracks from the selected composer

AIR CONDITIONING COMMAND	ACTION
Turn the AC on / off	Turns air conditioning system on or off
Change the fan speed to <#>	Changes the set fan speed of the air conditioning system to <#>
Set temperature to <#> degrees	Changes the set temperature of the air conditioning system to <#> degrees*
Increase / decrease temperature	Increases or decreases the temperature of the air conditioning system
Increase / decrease fan speed	Increases or decreases the fan speed of the air conditioning system

*Only within the possible temperature range of the air conditioning system.

NAVIGATION COMMAND	ACTION
Get directions to <house #, street, city, state>	Enables setting a destination by saying the address
Find a <POI category/POI name>	Displays a list of <POI category/POI name> near current position
Find a POI near my destination	Displays a list of <POI> near the destination
Find a <POI category> in a city	Displays a list of <POI> in a specified city and state
Go home	Displays the route to home
Go to favorite <1-10>	Sets the location registered to the corresponding favorite number
Show recent destinations	Displays recent destinations. Selecting a number from the list will start navigation to the selected recent destination.
Cancel route	Cancels the route guidance
Delete destinations	Displays a list of destinations to delete
Show <POI category> icons	Displays the specified point of interest category icons on the map
Destination assist	Connects the system to the Lexus response center



Works with
Apple CarPlay

3. ENABLE

Click “Enable Once” or “Always Enable” to enable CarPlay on your vehicle’s multimedia system.



If this popup is not shown, or if you want to change the setting later, go to Menu > Setup > General > Projection on your multimedia system and change the Apple CarPlay setting to ON.

5. LAUNCH APP

Now that CarPlay is active, you can click on any app to launch it. Your most recent apps will appear on the left side.

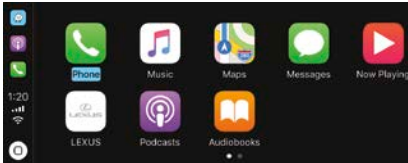

4. LAUNCH CARPLAY

To launch CarPlay, press the Menu button on your vehicle’s Remote Touch Interface, then select Apple CarPlay.



6. ACTIVATE SIRI

CarPlay features Siri voice control. To activate Siri, press and hold the Voice Command button on your steering wheel. You can also access the Lexus Voice Command system using a short tap.



Activate the included Wi-Fi hotspot trial in your Lexus, and connect up to 5 devices to the internet at the speed of 4G LTE.

1. ENABLE WI-FI HOTSPOT

Use the vehicle display screen to turn the Wi-Fi Hotspot on:
MENU > Setup > Wi-Fi



2. ACCESS POINT NAME

Select "Access Point Name" to view and make changes to the name.



3. CHANGE THE PASSWORD

Select "Password" and then "Change Password." Enter your desired password of at least 8 characters.



4. SEARCH

Connect your device to the access point.



5. SET UP

Open a web browser and follow instructions to set up an AT&T account.

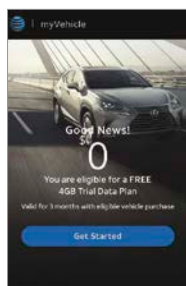



REMOTE TOUCH & TOUCHSCREEN

REMOTE TOUCH

Remote Touch is the primary way to operate the multimedia system. Use to select screens and perform various functions.

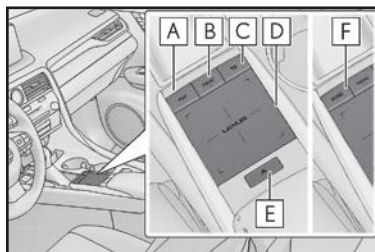

- A "MAP" button
- B "MENU" button
- C Back button
- D Touchpad
- E Sub function button
- F "HOME" button

Push Remote Touch buttons ("MAP"/"HOME", "MENU", Back) to change touchscreen display.

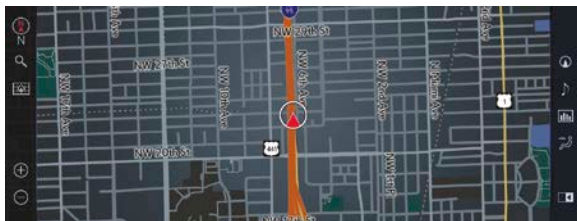

TOUCHSCREEN

Touch to make selections on the displayed screen.



12.3" Touchscreen shown; 8" Touchscreen similar

TIPS

Select  or  on the 12.3" screen* to switch between full and split screen.

When  is displayed on the screen, press  button on the Remote Touch.

The amount of feedback force on the Remote Touchpad can be adjusted:
Push "MENU", select "SETUP", select "General and scroll to "Feedback Force."



REMOTE TOUCH & TOUCHSCREEN

MAP ZOOM*

“Pinch” touchpad or touchscreen to zoom-in or zoom-out.

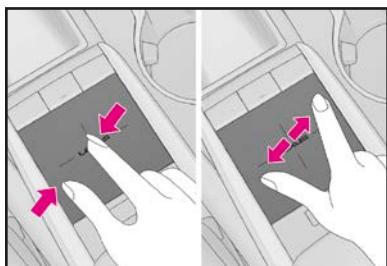

Slide fingers toward each other or apart on the touchpad to change the scale of the map.



Slide fingers toward each other or apart on the screen to change the scale of the map.

MAP SCROLL AND DRAG*



1. “Tap” one finger on screen or point and click with remote touch in desired direction. Repeat as desired.



2. To drag map, touch screen with two fingers and slide on screen (keeping fingers evenly spaced).

As a Lexus driver, there are several resources available to assist you with using and enjoying Lexus Enform products.

LEXUS TECHNOLOGY SPECIALIST

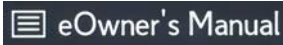

Call your dealer and ask for a Lexus Technology Specialist. You may also contact them via the “Technology” page of your dealer’s website. This vehicle and technology expert will be happy to assist you to register and use Lexus Enform products. Lexus Technology Specialist services are complimentary.

Download the Lexus app from the App Store® or the Google Play Store to get started.

www.LexusDrivers.com offers vehicle features and services information and more.

Contact Lexus Brand Engagement Center at (800) 255-3987.

An electronic User Guide with videos is available on the vehicle center screen. Select “Menu,” “Info,”



Available on certain models.

Always drive safely, obey traffic laws and focus on the road while driving.

DISCLOSURES:

Please be aware that smart device software updates can affect compatibility. Vehicle systems and connected services and software are subject to change. As a result, the content of this guide may differ from your devices, vehicle systems, and connected services. Visit www.LexusDrivers.com for the latest information.

1. Detailed information is provided in the Terms of Use.
2. Enform Safety Connect: Lexus Safety Connect depends on an operative telematics device, a cellular connection, and GPS signal strength and other factors outside of Lexus' control, all of which can limit system functionality or availability, including access to response center and emergency support. Stolen vehicle police report required to use Stolen Vehicle Locator. Registration required. Subscription required after trial. Service subject to change at any time without notice. Terms of Use apply. Data charges may apply. Service may vary by vehicle and region. See usage precautions and service limitations in Owner's Manual and Lexus.com/enform for additional details. To learn about Lexus' data collection, use, sharing and retention practices, please visit <https://www.lexus.com/privacyvts/>.
3. Information provided is based on the last time data was collected from the vehicle and is not real time data. Service Connect depends on an operative telematics device, a cellular connection, GPS signal strength and other factors outside of Lexus' control, which can limit functionality or availability. Service may vary by vehicle and region. Registration required. Subscription required after trial. Service subject to change at any time without notice. Terms of Use apply. Data charges may apply. See usage precautions and service limitations in Owner's Manual and Lexus.com/enform for additional details.
4. Use only if aware of circumstances surrounding vehicle and it is legal and safe to do so (e.g., do not remotely start engine if vehicle is in an enclosed space or vehicle is occupied by a child). Remote Connect depends on an operative telematics device, a cellular connection, GPS signal strength and other factors outside of Lexus' control, which can limit system functionality and availability. Service may vary by vehicle and region. Registration and app download required. Subscription required after trial. Terms of Use apply. Data charges may apply. Services subject to change at any time without notice. See usage precautions and service limitations in Owner's Manual and Lexus.com/enform for additional details.
5. Apps/services vary by phone/carrier; functionality depends on many factors. Select apps use large amounts of data; you are responsible for charges. Apps and services subject to change at any time without notice. See Lexus.com/Enform for details.
6. Navigation: Functionality, availability and accuracy of information provided by the system depends on many factors and service may not be available in every location. Use common sense when relying on information provided. Services and programming subject to change. Updates may be available from your dealer at an additional cost. See Owner's Manual for additional limitations and details.
7. Siri, iPhone, iPad, App Store and Apple: Are registered trademarks of Apple, Inc. All rights reserved.
8. Google Play is a registered trademark of Google Inc. All rights reserved.
9. Dynamic Navigation depends on an operative telematics device, a cellular connection, navigation map data and GPS signal strength and other factors outside of Lexus' control which can limit system functionality or availability. Services not available in every city or roadway. Use common sense when relying on information provided. Subscription required after trial. Terms of Use apply. Data charges may apply. See Owner's Manual and Lexus.com/enform for additional limitations and details. To learn about Lexus Enform's data collection, use, sharing and retention practices, please visit <https://www.lexus.com/privacyvts/>.
10. Eligible vehicle and wireless service required. Coverage and service not available everywhere. Valid in the contiguous U.S. and Alaska. Do not drive distracted. Go to att.com/toyota for terms and conditions.
11. Password required to Start/Stop Engine or Lock/Unlock Door. When using Alexa to Start/Stop Engine or Lock/Unlock Door, do so only if aware of circumstances surrounding vehicle and it is legal and safe to do so. Do not remotely start engine if vehicle is in an enclosed space or vehicle is occupied by a child. Amazon, Alexa and all related logos are trademarks of Amazon.com, Inc. or its affiliates. Certain functions require adequate signal strength and/or smartphone technology/connectivity. Not all Amazon Alexa functionality is available for in-vehicle use. See applicable app for details. Download of the Lexus+Alexa app is required to begin in-vehicle use of Alexa. Data charges may apply for certain functions. Apps and services subject to change at any time without notice. To learn more, go to lexus.com/enform. To learn more about Lexus Enform's data collection, use, sharing and retention practices, please visit <https://www.lexus.com/privacyvts/>.

12. Google Home: Google and Google Home are trademarks of Google LLC. Use Google Assistant™ to access Enform Remote only if aware of circumstances surrounding vehicle and it is legal and safe to do so (e.g., do not remotely start engine if vehicle is in an enclosed space or vehicle is occupied by a child). Functionality of Enform Remote depends on many factors outside of Lexus' control. Registration and app download required for Lexus Enform Remote. Data charges may apply. To learn about Lexus Enform's data collection, use, sharing and retention practices, please visit <https://www.lexus.com/privacypolicy/>. Actions and services subject to change at any time without notice. To learn more, go to [Lexus.com/enform](https://www.lexus.com/enform).
13. Apple CarPlay®: Apps and services are subject to change at any time without notice. Data charges may apply. Apple CarPlay® functionality requires a compatible iPhone® connected with an approved data cable into the USB media port. Apple CarPlay is a registered trademark of Apple Inc. Requires internet access. See apple.com and phone carrier for details. Not all Siri functionality available for in-vehicle use. Siri® is a registered trademark of Apple Inc.
14. Android Auto™: To use Android Auto on your audio display, you'll need an Android Auto compatible vehicle and Android phone. For phone compatibility visit: <https://www.android.com/aut/>. Requires compatible smartphone connected with an approved data cable into the USB media port and data plan rates apply. Apps and services vary by phone carrier and are subject to change at any time without notice.
15. Apple Podcasts and iPhone are trademarks of Apple Inc. All rights reserved. Spotify is a registered trademark of Spotify Technology Holding. iHeartRadio is a registered service mark of iHeartMedia, Inc.
16. Be sure to obey traffic regulations and maintain awareness of road and traffic conditions at all times.
17. The Bluetooth word mark and logos are registered trademarks owned by Bluetooth SIG, Inc. and any use of such marks by Lexus is under license. A compatible Bluetooth enabled phone must first be paired. Phone performance depends on software, coverage and carrier.

Available features shown. Features and images shown may differ from your vehicle. Features, equipment, and options are based upon information available at time of printing, are subject to change without notice, are for continental USA vehicles only. Some vehicles may be shown with optional equipment. Optional equipment listed may not be available separately or in all regions.

LEXUS SAFETY SYSTEM+™ Features, Operations, Limitations and Precautions

A. Drivers should always be responsible for their own safe driving. Please always pay attention to your surroundings and drive safely. Depending on the conditions of roads, vehicles, and weather, etc., the system(s) may not work as intended. See Owner's Manual for details. **B.** The Lexus Safety System+ Pre-Collision System is designed to help avoid collisions or reduce the crash speed and damage in certain frontal collisions only. It is not a substitute for safe and attentive driving. System effectiveness is dependent on road, weather and vehicle conditions. See Owner's Manual for additional limitations and details. **C.** Lane Departure Alert is designed to read lane markers under certain conditions, and provide visual and audible alerts when lane departure is detected. It is not a collision avoidance system or a substitute for safe and attentive driving. Effectiveness is dependent on road, weather and vehicle conditions. See Owner's Manual for additional limitations and details. **D.** Intelligent High Beams operate at speeds above 25 mph. Factors such as a dirty windshield, weather, lighting and terrain limit effectiveness requiring driver to manually operate the high beams. See Owner's Manual for additional limitations and details. **E.** The Pre-Collision System (PCS) with Pedestrian Detection (PD) is designed to determine if impact is imminent and help reduce impact speed and damage in certain frontal collisions involving a vehicle, or a pedestrian. PCS w/PD is not a substitute for safe and attentive driving. System effectiveness depends on many factors, such as speed, size and position of pedestrian and weather, light and road conditions. See Owner's Manual for additional limitations and details. **F.** Dynamic Radar Cruise Control is designed to assist the driver and is not a substitute for safe and attentive driving practices. System effectiveness is dependent on road, weather and traffic conditions. See Owner's Manual for additional limitations and details. **G.** Do not rely exclusively on Road Sign Assist (RSA). RSA is a driver support system that utilizes the vehicle's forward facing camera and navigation system (when data is available) to recognize certain road signs and provide information to the driver via the multi-information display and/or Head-Up display. Effectiveness is dependent on road, weather, vehicle and sign conditions. Use common sense when using RSA and do not drive distracted. See Owner's Manual for additional limitations and details. **H.** Lane Tracing Assist (LTA) is designed to read visible lane markers and detect other vehicles under certain conditions when DRCC is engaged. When potential lane departure is detected, LTA provides a visual warning and either an audible alert or vibration in the steering wheel and can apply a slight steering force. It is not a collision-avoidance system or a substitute for safe and attentive driving. Effectiveness is dependent on many factors including road, weather and vehicle conditions. See Owner's Manual for additional limitations and details.



21-LCS-16028
© 2021 Lexus
Printed in USA (09/21)



MIX
Paper from
responsible sources
FSC® C018793